

GENERAL NOTES

- EXISTING WALL (FRP) SHALL BE CLEANED
- EXISTING CEILING TILES (NSF) APPROVED FOR FOOD SERVICE USE SHALL BE CLEANED
- EXISTING FLOOR SHALL BE CLEANED
- ALL POISONOUS OR TOXIC MATERIALS SHALL BE STORED IN CABINETS OR IN A SIMILAR PHYSICALLY SEPERATE PLACE USED FOR NO THER PURPOSE AND SEPERATED BY TYPE.
- REAR ALLEYWAY IS A REQUIRED MEANS OF EGRESS FOR THIS BUILDING AND SEVERAL OTHERS. THE ALLEY SHALL BE MAINTAINED IN A CLEAN, UNCLUTTERED MANNER WITH ADEQUATE CLEAR WIDTH FOR EGRESS.

GENERAL FINISH NOTES

- NEW INTERIOR FINISHES TO BE CLASS "C" OR BETTER.
- THE WALLS, CEILINGS AND FLOORS OF THE KITCHEN, FOOD STORAGE AREAS, MOP ROOM, RESTROOMS, BAR AND DISHWASH ROOM MUST BE SMOOTH EASILY CLEANABLE, DURABLE, NONABSORBANT

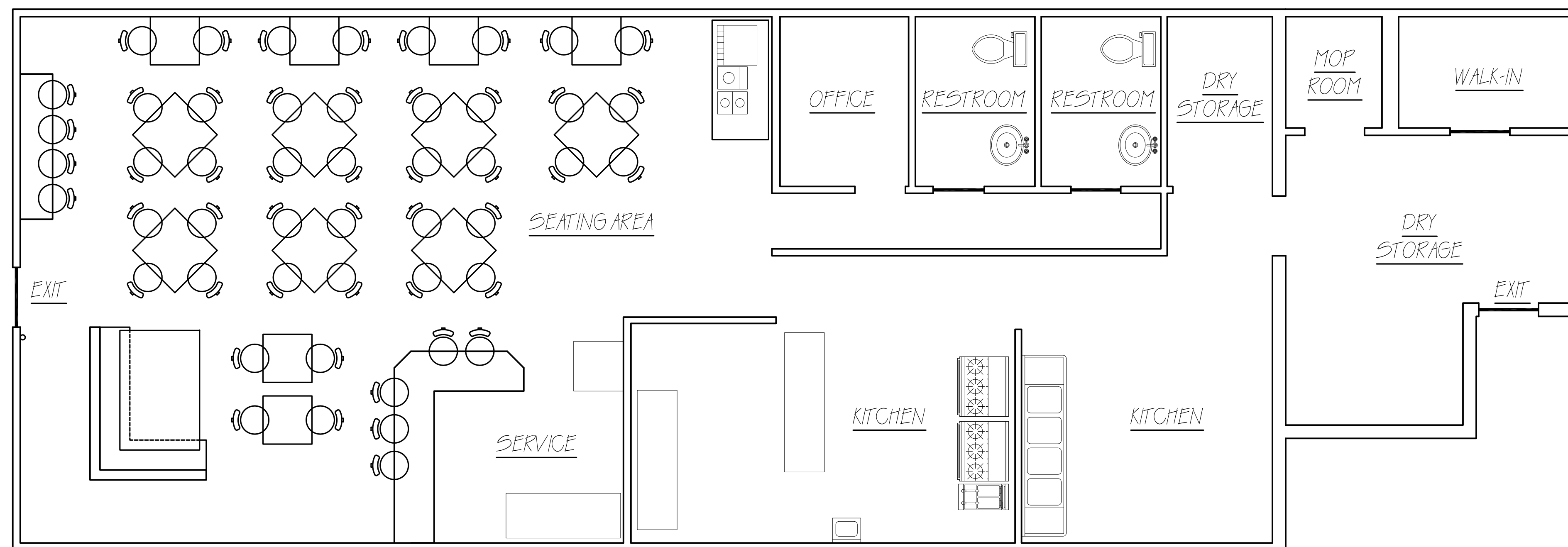

1 FURNITURE, FIXTURE & EQUIPMENT PLAN
A1.0 SCALE: 1/4" = 1'-0"

EQUIPMENT SCHEDULE

EQ #	EQUIPMENT	MANUFACTURER	ELEC. REMARK - (SEE SHEET E.I.)	EQ #	EQUIPMENT	MANUFACTURER	ELEC. REMARK - (SEE SHEET E.I.)
EQ-1	ORDER COUNTER	CUSTOM (60" X 20" X 56")		EQ-18	DOUBLE DOOR COOLER	TRUE T-49F	
EQ-2	CASH REGISTER	TO REMAIN EXISTING		EQ-19	GREASE TRAP	TO REMAIN EXISTING	
EQ-3	MICROWAVE			EQ-20	55 WORK TABLE	TO REMAIN EXISTING	
EQ-4	WALK-IN COOLER	MR. WINTER, MODEL # 50A036WA	REFER TO INSTALLATION GUIDE AND SPECS	EQ-21	FIRE EXTINGUISHER (K-CLASS)		
EQ-5	HAND SINK	TO REMAIN EXISTING		EQ-22	VEGETABLE SINK	TO REMAIN EXISTING	
EQ-6	PREPERATION COOLER	TO REMAIN EXISTING		EQ-23	FIRE EXTINGUISHER	TO REMAIN EXISTING	
EQ-7	PREPERATION COOLER	TO REMAIN EXISTING		EQ-24	FLOOR MOP SINK	TO REMAIN EXISTING	
EQ-8	55 PRFR	IMPERIAL, MODEL # IF5-40		EQ-25	DRAIN SHELVES	TO REMAIN EXISTING	
EQ-9	36" RANGE - 6 BURNER	U.S. RANGE, MODEL # U56-6R		EQ-26	SODA FACTORY/ ICE BIN	CORNELLUS DP150RC	
EQ-10	36" RANGE - 6 BURNER	U.S. RANGE, MODEL # U56-6R		EQ-27	COFFEE MAKER	BUNN C08CF15-APS	
EQ-11	COMPUTER DESK	TO REMAIN EXISTING		EQ-28	ICE TEA MAKER	TO REMAIN EXISTING	
EQ-12	WATER HEATER	TO REMAIN EXISTING		EQ-29	HAND SINK	TO REMAIN EXISTING	
EQ-13	ICE MAKER/ BIN	TO REMAIN EXISTING		EQ-30	BEVERAGE COOLER	TO REMAIN EXISTING	
EQ-14	HAND SINK	TO REMAIN EXISTING		EQ-31	CHP WARMER	WELLS RW-3	
EQ-15	4-COMPARTMENT SINK	TO REMAIN EXISTING		EQ-32	UNDERBAR REFRIGERATION UNIT	TRUE 1DD-5	
EQ-16	PREP TABLE	TO REMAIN EXISTING		EQ-33	EMPLOYEE STORAGE UNIT		
EQ-17	FREEZER	TO REMAIN EXISTING		EQ-34	SHELVING UNIT	CUSTOM (60" X 52 1/2" X 21")	

GENERAL CONDITIONS

GENERAL CONTRACTOR SHALL BE HELD RESPONSIBLE FOR THE COORDINATION AND EXECUTION OF ANY AND ALL WORK IN ACCORDANCE WITH THE TRUE INTENT OF THE DRAWINGS AND SPECIFICATIONS WHICH ARE IN EFFECT. GENERAL CONTRACTOR IS RESPONSIBLE FOR A COMPLETED HIGHEST QUALITY CONSTRUCTION. GENERAL CONTRACTOR SHALL FURNISH ALL LABOR AND MATERIALS REQUIRED.

CONTRACTOR SHALL VERIFY AND CHECK ALL DIMENSIONS. ANY CHANGES IN PLANS OR SPECIFICATIONS ARE TO BE APPROVED BY THE DESIGNER OR THE DEESIGNER'S REPRESENTATIVE.

ALL WORK TO COMPLY WITH STATE AND LOCAL CODES. IT IS THE GENERAL CONTRACTOR'S RESPONSIBILITY TO SECURE ALL PERMITS NECESSARY FOR COMPLETION OF THE JOB.

ALL KITCHEN EQUIPMENT IS TO BE INSTALLED BY THE OWNER'S SUPPLIER, UNLESS SPECIFIED OTHERWISE BY THE OWNER, AND CONNECTED BY THE CONTRACTORS. GENERAL CONTRACTOR IS TO COORDINATE EQUIPMENT INSTALLATION DATE WITH EQUIPMENT SUPPLIER.

NO.	DATE	REVISIONS DESCRIPTION

CLIENT **saba**
CONTACT : SHANE MIXON (770) 906-0070
1451 OXFORD ROAD NE, ATLANTA, GEORGIA

DESIGN PLANS FOR **saba**
1451 OXFORD ROAD NE
DEKALB COUNTY, GEORGIA

GREYDEN
ENGINEERING LLC
5285 Hunters Oaks Drive
Alpharetta, Georgia 30004
770-573-4801

ENGINEER'S SEAL & SIGNATURE	
DATE	01/22/08
JOB NO.	08-005
DESIGNED	RAD
CHECKED	RAD
SHEET:	A-1.0